

# THRUXTON CENTRE

EVENTS | HOSPITALITY | CONFERENCES | EXHIBITIONS





# INTRODUCTION

## HISTORY OF THRUXTON

Thruxton was originally a wartime airfield. Commissioned in 1941 the airfield was host to both the RAF and USAF and played a major part in the D-Day landings as a base for troop-carrying aircraft and gliders.

Motorsport started in 1950 on a track comprising both the runways and perimeter roads. As the deteriorating wartime tarmac was breaking up, plans were underway to redevelop the site.

Motor racing returned on a new track in 1968. The new layout followed the lines of the perimeter road with the inclusion of a chicane and three tight corners in succession. Even with these tight corners, Thruxton is the fastest race circuit in the UK. Thruxton quickly gained a reputation as a real drivers circuit, where success requires total commitment.

Thruxton's fame grew from the Easter Monday Formula 2 meetings where Formula 1 drivers of the day; Graham Hill, Jackie Stewart and Jochen Rindt all thrilled the crowds.

Since then, Thruxton has seen current Formula 1 drivers race at the track at some time in their career. It is now the high-speed rounds of the British Touring Car Championship and British Superbike Championship that regularly bring in capacity crowds.

## THRUXTON TODAY

In addition to the circuit, Thruxton is home to a state-of-the-art skid pan facility, a purpose-built kart centre, featuring three different circuits and a 4x4 off-road driving course.

**THE NEW THRUXTON CENTRE IS THE PERFECT ADDITION TO THE VENUE. PROVIDING A TRULY UNIQUE EVENT, HOSPITALITY, CONFERENCE AND MEETING FACILITY.**





# THRUXTON CENTRE

The Thruxton Centre is a ground-breaking event, conference, meeting and exhibition facility, set in the unrivalled setting of a breath-taking sporting arena. Set over two floors and with a footprint of over 1400 m2, the flagship hospitality facility boasts an array of versatile, modern suites and event spaces.

This unique venue provides all the expected facilities to deliver stunning and memorable events. The Thruxton Centre is the perfect venue for events, meetings, conferences, awards, banqueting, exhibitions and much more.

## KEY FEATURES

RESTAURANT AND BAR

EXHIBITION SPACE

FUNCTION ROOMS

HOSPITALITY SUITES

CLASSROOMS

VIEWING TERRACE

BALCONY

PARKING ON-SITE

CATERING FACILITIES

LIFT ACCESS

DISABLED FACILITIES





## THRUXTON CENTRE

# GROUND FLOOR

A grand atrium entrance lobby greets guests when they walk in to the Thruxton Centre.

Located on the ground floor is the main restaurant and bar which turns in to 330 m2 of exhibition space. Access to bring in vehicles/large items to this space is also available.

Also located on the ground floor are two classrooms, which can be joined to form a single larger space. Lift access to the first floor, male and female toilets, including disabled facilities. Plus, kitchen and service areas.





# THRUXTON CENTRE FIRST FLOOR

The first floor of the Thruxton Centre offers stunning views of the race circuit (the fastest in the UK) and the rest of the venue.

Located on the first floor is a 135 m2 hospitality space, which can also be divided in to three separate hospitality suites, each with 45 m2 of floor space. Step outside on to the viewing terrace and balcony with unrivalled views of Thruxton.

Also located on the first floor are male and female toilets, including a disabled toilet. Plus, a meeting room and catering service areas.





# THRUXTON CENTRE

## GROUND FLOOR

### DIMENSIONS

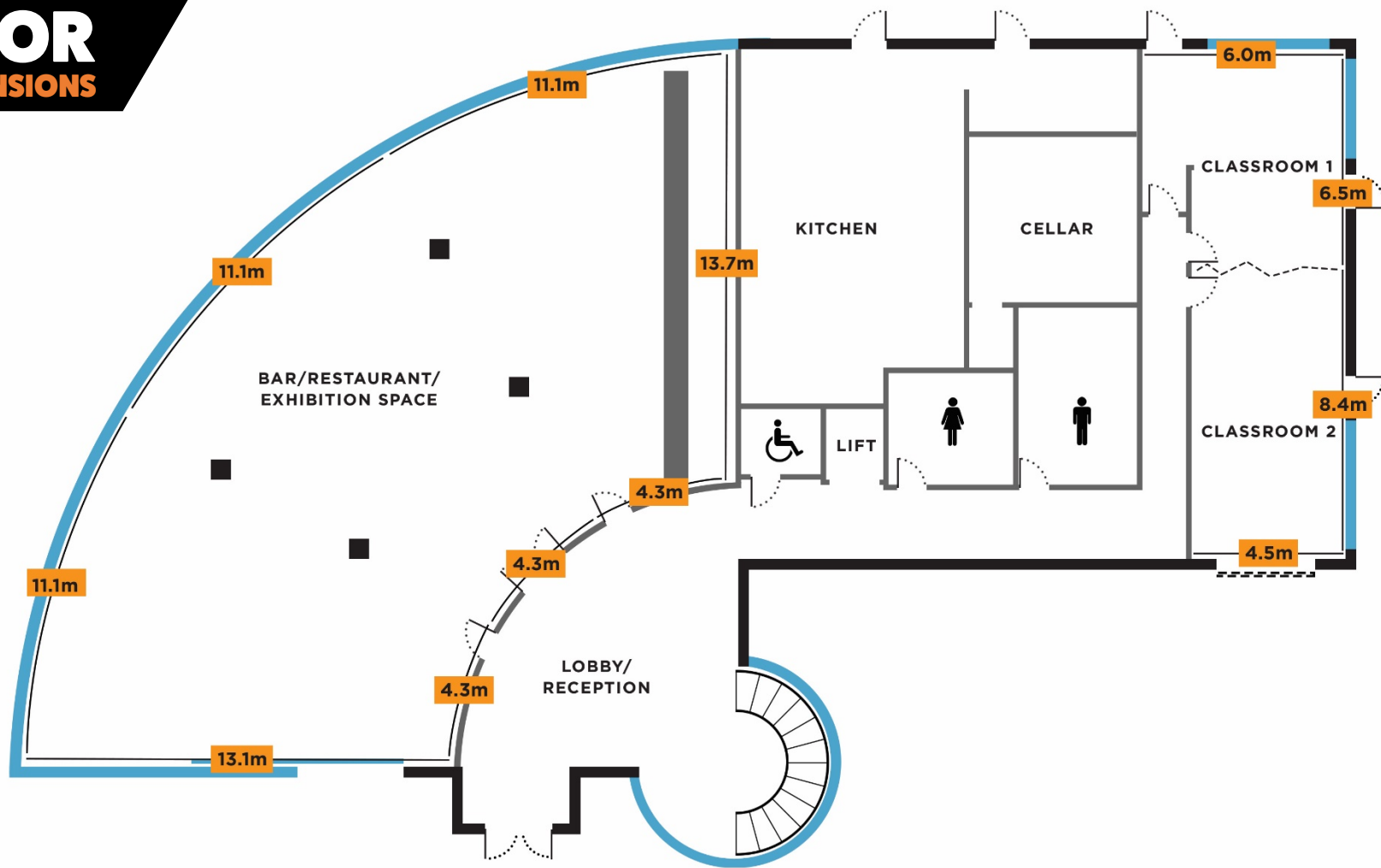







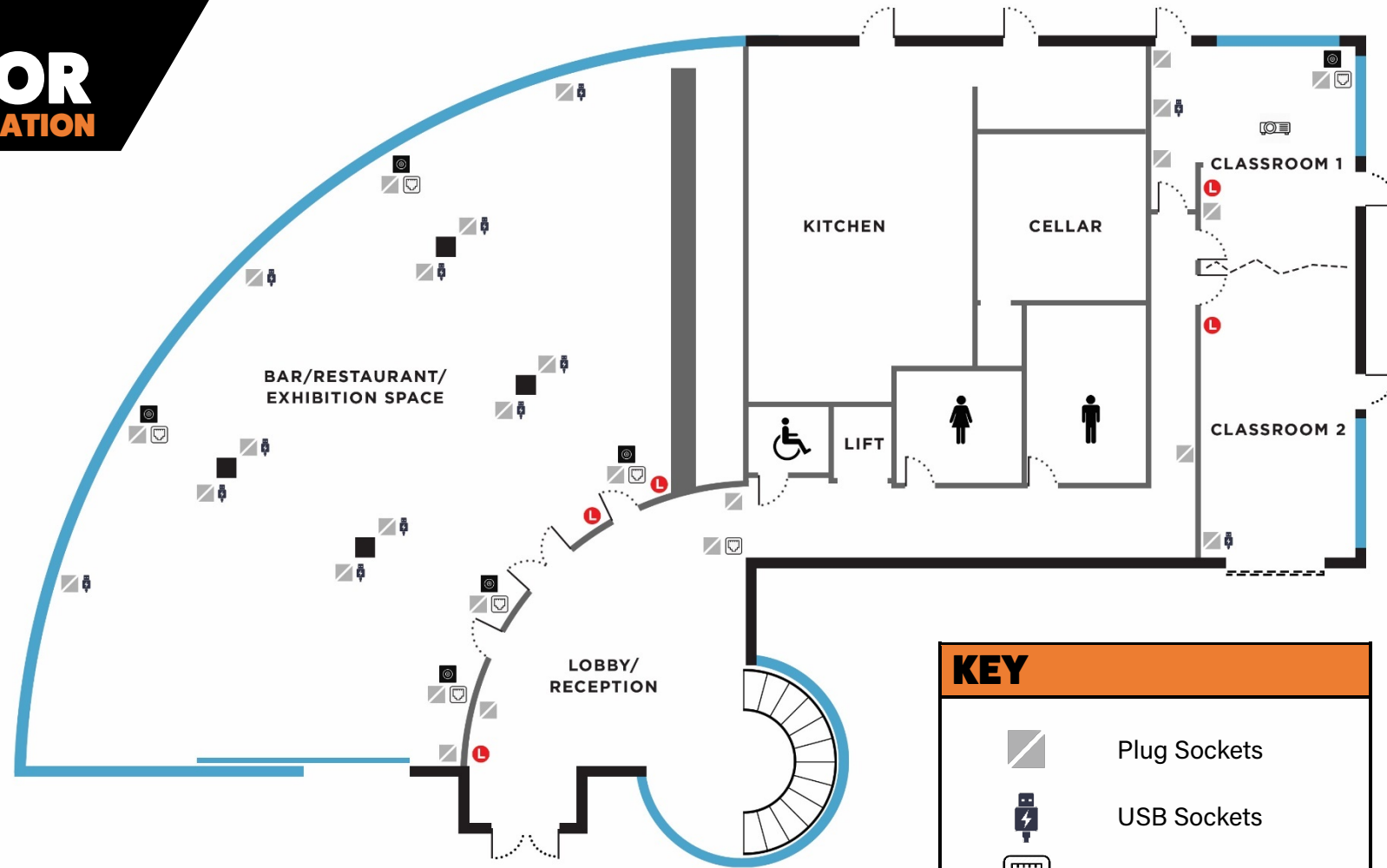
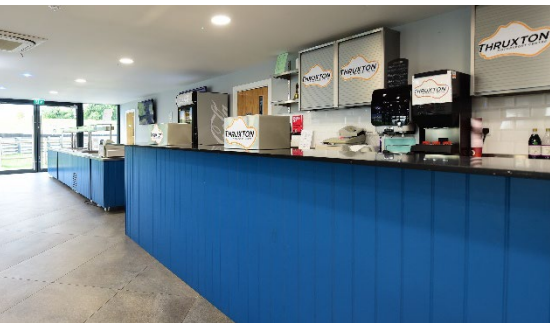

	FLOOR SPACE		
	Area M2	Max Length (Metres)	Max Width (Metres)
Restaurant/Exhibition Space	330	33.2	9.7
Classroom 1	41	6.5	6.8
Classroom 2	46	8.4	4.5
Classrooms Combined	87	15.2	6.8



# THRUXTON CENTRE GROUND FLOOR SPECIFICATION

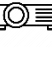

## KEY

-  Plug Sockets
-  USB Sockets
-  Network Point
-  TV Aerial
-  Projector
-  Pillar
-  Windows
-  Light Switch



# THRUXTON CENTRE FIRST FLOOR DIMENSIONS

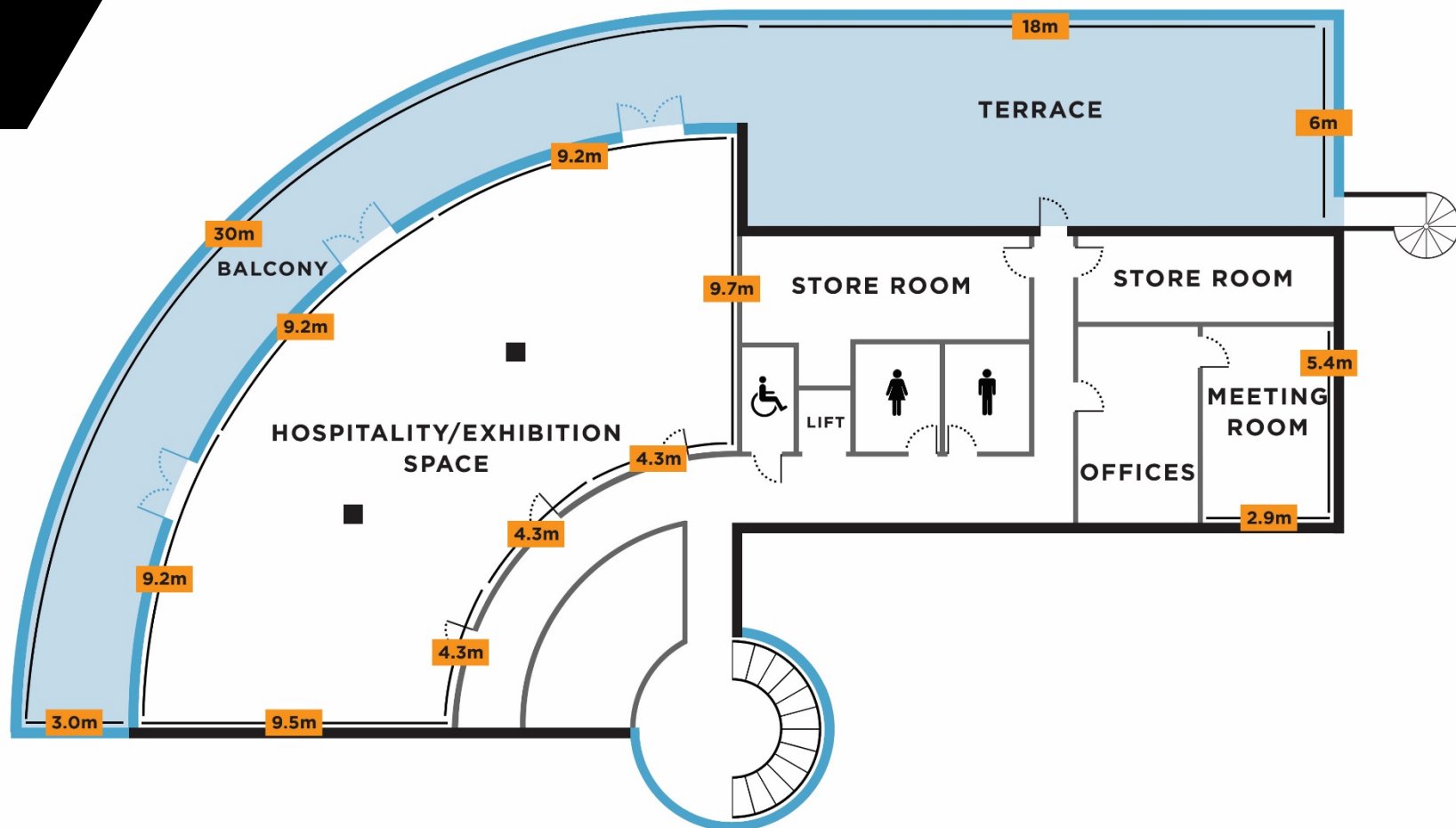







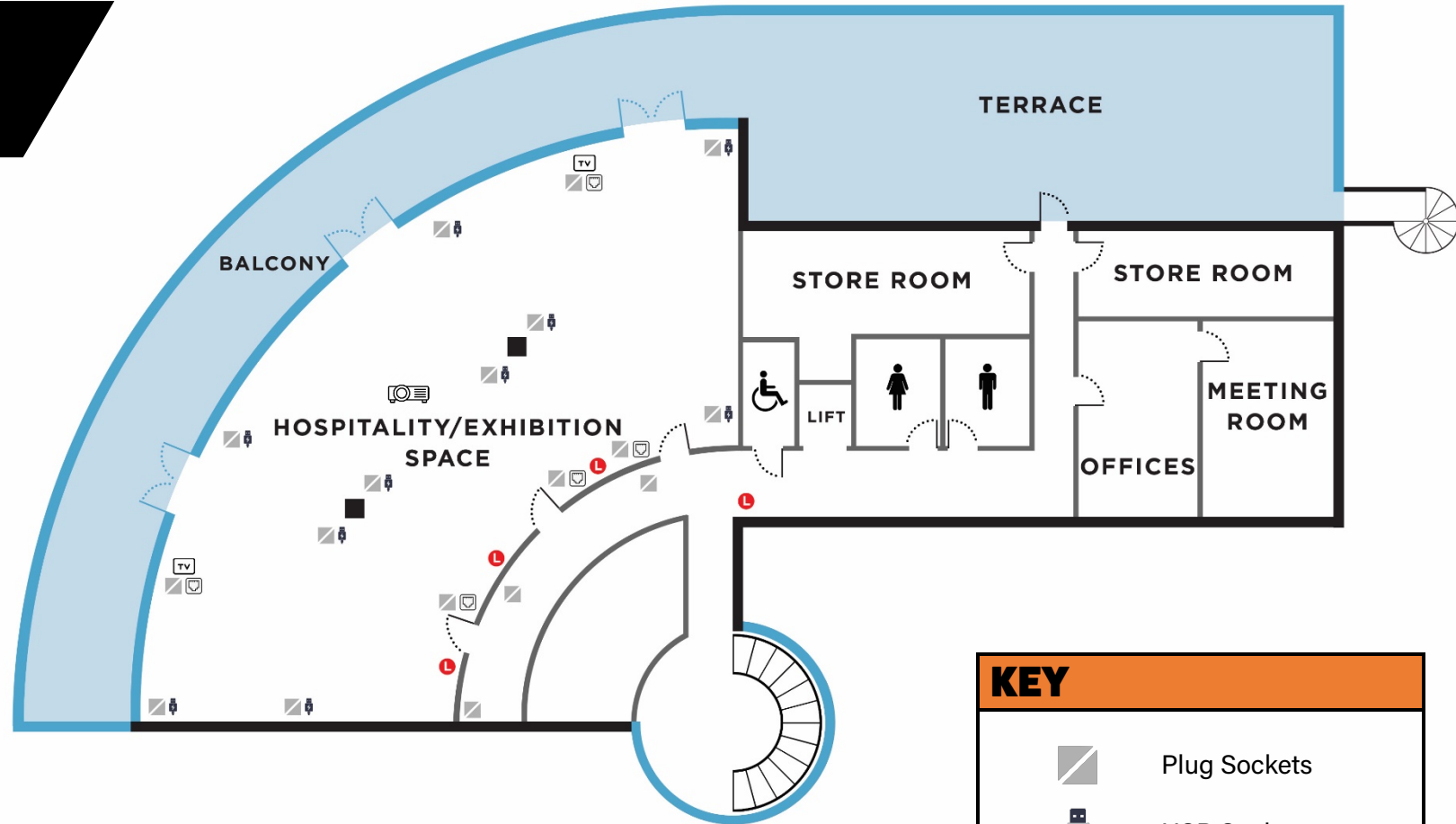
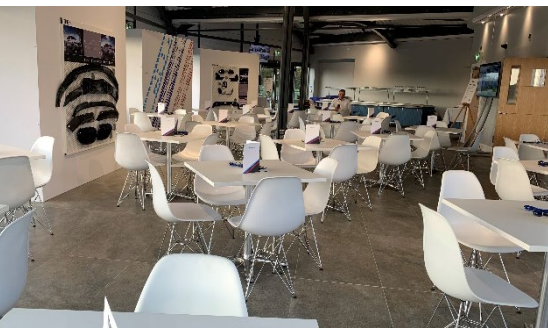

	FLOOR SPACE		
	Area M2	Max Length (Metres)	Max Width (Metres)
Exhibition Space	135	27.7	9.7
Meeting Room	8.9	5.4	2.9
Balcony	90	30	3
Terrace	108	18	6



# THRUXTON CENTRE FIRST FLOOR SPECIFICATION

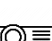

## KEY

-  Plug Sockets
-  USB Sockets
-  Network Point
-  TV Aerial
-  Projector
-  Pillars
-  Windows
-  Light Switch



# THRUXTON CENTRE LAYOUTS OPTIONS

The Thruxton Centre features adaptable, versatile rooms and spaces with multiple layout options. Below are some layout types to show how the space can be used.

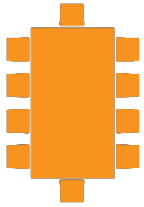

Boardroom



U-Shape

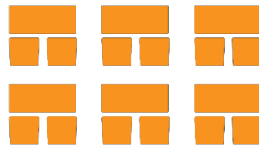

Seminar

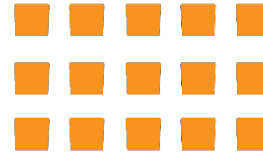

Theatre

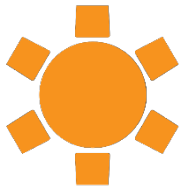

Banquet



Cabaret



Drinks

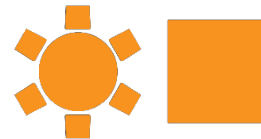

Dinner w/Dancefloor

## KEY FEATURES

ALL EVENT ROOMS HAVE  
NATURAL DAYLIGHT

LATEST AV TECHNOLOGY

COMPLIMENTARY  
100MB WI FI

CIRCUIT VIEWS

BLACKOUT EQUIPMENT

DISABLED FACILITIES

VEHICLE ACCESS

OUTSIDE SPACE

LIFT ACCESS



# CATERING

The Thruxton Centre has been designed to offer guest catering services to the highest standard and capable of hosting hundreds of guests over two floors.

We understand that exceptional food & drink can enliven even the most demanding meeting or event. Indeed, good food can boost your meeting's productivity and do wonders for your attendees' event experience.

Our dedicated and experienced events and on-site catering team, work with clients to prepare and deliver menus for any occasion, that are as inspiring as the setting.

Our chefs have also created a number of different menu options for you to select from.

Catering is prepared on site and hosted by our experienced team.





# THRUXTON AIRPORT

Thruxton airport features two runways, one asphalt and one grass, situated inside the race circuit.

The asphalt runway ensures there is never a problem getting in and out of Thruxton, whatever the conditions.

The airport is also suitable for helicopters.

There's plenty of open parking on grass or asphalt as well as open-fronted hangar ports or fully secured hangars.

AvGas and Jet A1 are available on site.





# GALLERY

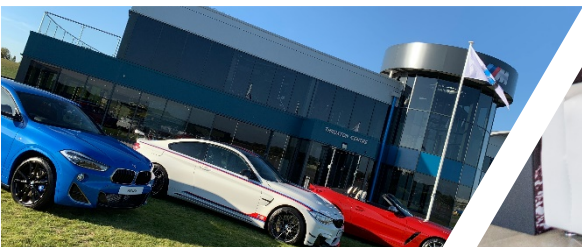



# DIRECTIONS

## BY CAR

Thruxton is readily accessible from both the M3 and M4. Once on the A303 follow the signs for Thruxton Circuit ONLY; ignore signs for Thruxton village.

Upon leaving the A303 follow signs for Thruxton Circuit.

## THRUXTON CENTRE

Proceed through the main Circuit/Airfield entrance, along the tree-lined drive (20 mph max speed).

At the top there is a large location sign to your left, carry straight on through the tunnel (4.5-metre height limit) this leads directly into the 'paddock' area.

The Thruxton Centre is the large grey & blue glazed building to your left.

## FOLLOWING SATELLITE NAVIGATION

If using Satellite Navigation to travel to Thruxton, either put Thruxton Circuit as a location or use the circuit postcode **SP11 8PN**.

## TRAINS AND PLANES

There is a mainline train station in Andover (10 minutes away), which runs from Waterloo. Southampton Airport is the closest mainstream airport (45 minutes away). Heathrow is 1 hour away.

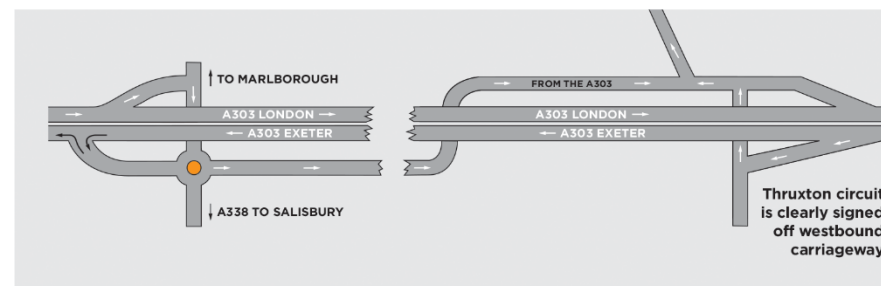
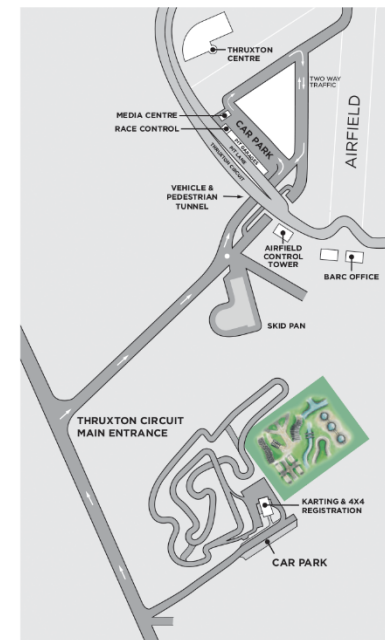



# CONTACT



**For more information, contact our team:**

**Tel:** 01264 882222

**Email:** [lorne@thruxtonracing.co.uk](mailto:lorne@thruxtonracing.co.uk)

**Web:** [thruxtonracing.co.uk](http://thruxtonracing.co.uk)







Whether you are looking to host an important corporate event, a memorable gala dinner, or an exquisite private party, our dedicated and experienced team will work with you to create events that are as inspiring as the setting.

Our location on the Hampshire/Wiltshire border is extremely accessible for visitors, with excellent transport links no matter where your guests are travelling from.



**/thruxtonracing**



**@thruxtonracing**



**@thruxtonracing**

Thruxton Circuit | Andover | Hampshire | SP11 8PN

**Tel:** 01264 882222 | **Web:** [thruxtonracing.co.uk](http://thruxtonracing.co.uk)